

Tools You Will Need

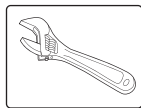

Silicone Caulking



Adjustable Wrench

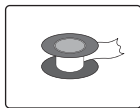

Pipe Tape

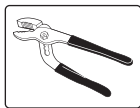

Groove joint plier

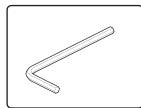

Allen Wrench

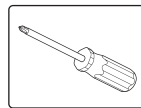

Phillips Screwdriver

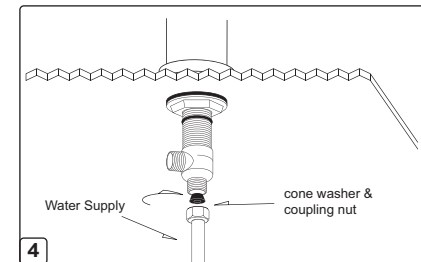
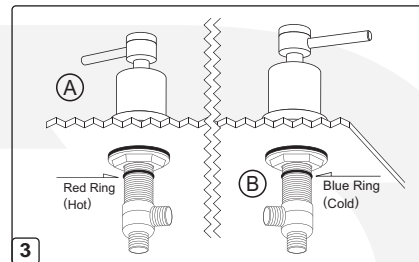
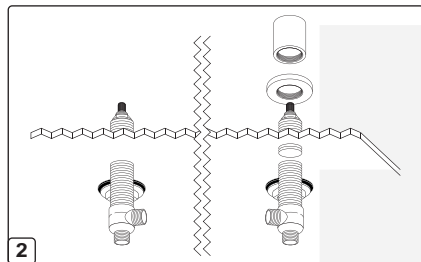
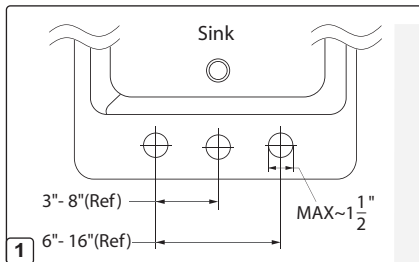

Before beginning installation:
First make sure to read through the installation guide carefully. If you are using a solid surface counter top and holes need to be custom drilled follow the guide lines above. Each hole should be carefully measured and planned in reference to the sink / basin being installed. (Hint: pay close attention to the spout length of the faucet) Each hole must not be drilled larger than 1.5" in diameter. Also, the distance from the two handle holes must be between 6" - 16" apart. Most standard holes are drilled 1 3/8" diameter. Drill the holes carefully and measure out each distance holes distance. Holes are always measured to the center point of each hole.

Installing the valve assemblies:
A. First make sure that the lock nut and washer are installed on to both of the valves. Screw the locks nut all the way to the bottom of each valve. Next, from underneath the deck surface slide the hot side valve assembly up through left hole in counter.
B. Next from the top screw on the round escutcheon flange. Screw it down onto the neck of the valve until there is approx. 1/4" of valve neck thread left above the flange.
C. Next, from underneath the counter top hand tighten the bottom lock nut of the valve such that the valve is in position yet can be easily adjusted.
D. Install the escutcheon base onto the valve screwing it down until it touches the flange. Screw the escutcheon down good and tight so that it is secure. Next, make sure that the valve is in the off position

Install the handles & set the valves:
A. Install the handle tip such that the lever handle is facing outward when the valve is in the off position. (for cross handle install in desired position) and tight down the screw securing the handle tip.
B. After the handle tip is secured you can adjust the position of the handles by rotating / adjusting the valve body (this is why you only hand tighten the bottom lock nut). Once the valve and handles are in desired position tighten the bottom lock nut until valve is secure. (caution: Do not over tighten)
C. Once the valve body is secure. Place the handle tip screw cover cap on the handle.
D. Do the same for the cold side.

(Note: The height of the valve can be adjusted by either tightening and loosening the bottom lock nut and escutcheon)

Install the water supply hoses:
From underneath the sink install the water supply hose from the angle stop in the wall to the bottom inlet of the valve body. Many homes that have existing faucets have 3/8" compression fitting supply lines that can be reused. These supply lines will attach to the valve body using a cone washer and coupling nut. (HB recommends using new washers and nuts with each new installation)
Be sure to tight the nut down until secure (Do not over tighten or washer will get damaged)

Flex hose supply lines can also be used. These supply line are not provided by HB, but can be purchased and most plumbing or hardware stores.

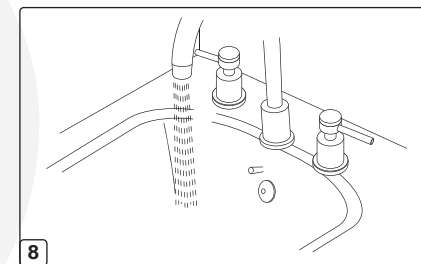
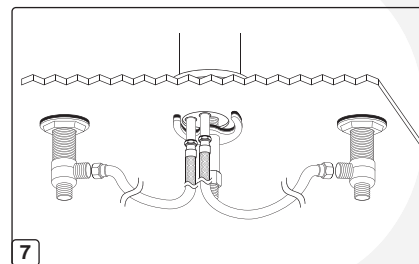
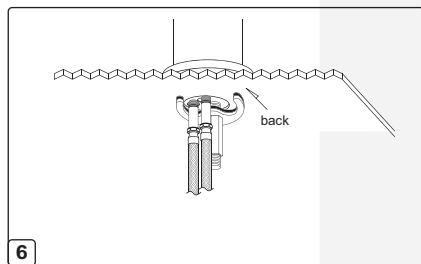
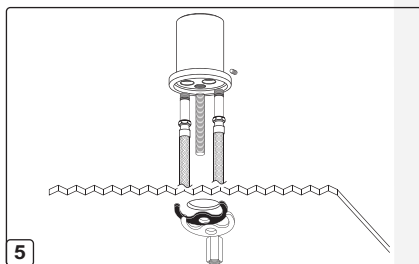

Installing the spout:
A. On the bottom of the spout base insert the mounting bolt screw by screwing it into the bottom of the spout. Use a screw driver to lock in place. It is also possible to use a small amount of thread lock glue on the threads of the mounting bolt.
B. Next, insert the a water supply lines into the bottom water inlet connection on the bottom of the spout. Screw it in hand tight, then with an adjustable wrench gently tighten the supply hose until secure, make sure you tighten at the lock nut portion of the hose. (Caution: Do Not Overtighten, and do not pinch the lines) Do the same for the other hose.
C. Place the spout ring over the center hole, make sure opening for the pop up rod on the spout ring is to the back of the sink.

Tighten the lock nut:
A. From underneath sink, place the rubber gasket and metal washer on mounting bolt. Make sure crescent-shaped slot in metal washer is to the back. Screw mounting nut onto mounting bolt and hand tighten.
B. Adjust the position of the spout so that it is centered over the hole and make sure that no part of the hole is exposed. Use a wrench and tighten the mounting bolt until the spout is secure.

(Note: make sure the pop up opening on spout and on the spout ring stays in place and lines up.)
(Hint: with the help of an associate, from the top have them hold the spout while you tightening the lock nut from underneath. This will make for a much easier installation)

Connecting the water supply lines to the hot and cold valves:
With the HB T-less design installing the water supply lines is as simple as it gets. Simply screw the hex nut ends of each supply lines to the side outlet of one of the valve bodies. (See picture)
Hand tighten each connection. Then use a wrench tighten one more 1/2 turn securing the connection. (Caution: Do not overtighten or the washers may get damaged)

(Caution: Make sure to check all connections for leakage with testing the faucet after installation)

Flushing system:
To flush the system turn the main water supply back on making sure that the faucet handles are in the off position any water hammer issues. Open a few other faucets around the house to avoid any water hammer issues.
Unscrew and remove the aerator. Turn both faucet handles into the on position and let the water run for two to three minutes. Check for any problems with the function of the faucet, and check for leaks at all connection points. Turn the handles into the off position. Replace the aerator back on the spout.

